

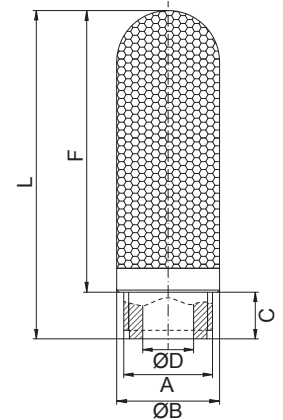

**S19** Nipplo: Polietilene Parte filtrante: Polietilene poroso 50 µm  
 Nipple: Polyethylene Filter: Porous polyethylene 50 µm

	Codice Code	Articolo Article	A	ØB	C	ØD	F	L	Confezione Order Q.ty
<b>Polietilene</b> Polyethylene	10138D	S19M5	M5	6,8	4	2,6	17,8	21,8	100
	10139D	S1918	1/8"	12,7	6,7	5	27,8	34,5	100
	10140D	S1914	1/4"	16,5	8,9	7,5	33,9	42,8	50
	10141D	S1938	3/8"	20	11	10	56	67	50
	10142D	S1912	1/2"	24,3	11	12	66,5	77,5	25
	10143D	S1934	3/4"	38	15,5	16	115,5	131	10
	10144D	S1901	1"	48	20	22	140	160	5



**SN19** Nipplo: Polietilene Parte filtrante: Polietilene poroso 50 µm  
 Nipple: Polyethylene Filter: Porous polyethylene 50 µm



	Codice Code	Articolo Article	A	ØB	C	ØD	F	L	Confezione Order Q.ty
<b>Polietilene</b> Polyethylene	10139ND	SN1918	1/8"NPT	12,7	6,7	5	27,8	34,5	100
	10140ND	SN1914	1/4"NPT	16,5	8,9	7,5	33,9	42,8	50
	10141ND	SN1938	3/8"NPT	20	11	10	56	67	50
	10142ND	SN1912	1/2"NPT	24,3	11	12	66,5	77,5	25
	10143ND	SN1934	3/4"NPT	38	15,5	16	115,5	131	10
	10144ND	SN1901	1"NPT	48	20	22	140	160	5

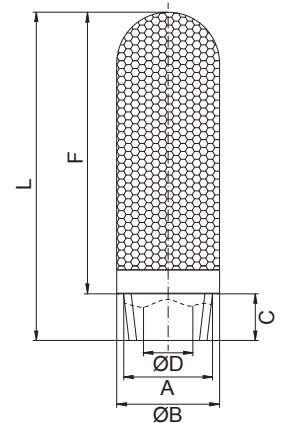

**S22** Nipplo: Polietilene Parte filtrante: Polietilene poroso 50 µm  
 Nipple: Polyethylene Filter: Porous polyethylene 50 µm



	Codice Code	Articolo Article	ØA	ØB	ØC	ØD	F	G	L	S	Confezione Order Q.ty
<b>Polietilene</b> Polyethylene	10208D	S224	4	7	5	2,65	16	15,5	31,5	14,2	100
	10209D	S226	6	12,5	8	3,5	24,5	20,5	45,2	17	100
	10210D	S228	8	13,5	10	4,9	22	21,5	43,5	18	100
	10211D	S2210	10	15,5	12,2	7	31	26,5	57,5	22,6	50
	10212D	S2212	12	18,5	14,2	8,4	54	29	83	24,7	50

